

Baseplate stainless steel

2104

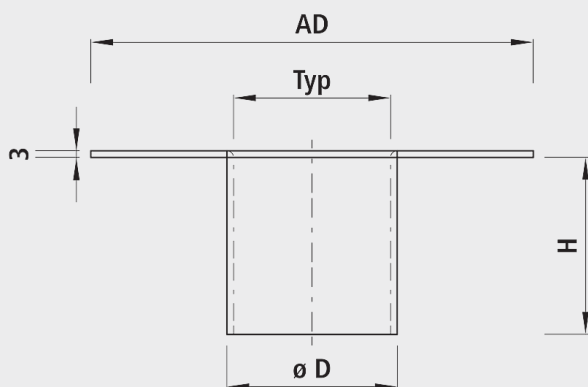

Application

- Non-siphoned base plate for the Hawle drain and overflow type N and type OS
- For the restoration of drains and overflows in well chambers

Material

- Plate: INOX 1.4306
- Rubber seal: EPDM

Installation and assembly

- Seal the base plate with a sealing mat and attach to the well chamber floor with bolts.
- Special sizes are available on request

Caution

- x = Rubber seal

	Type		ø D	AD (mm)	H (mm)	weight (kg)	NPK No. 411
2104050000	50		78	200	80	1.000	842551
2104050010	50	x	78	200	4	0.130	
2104075000	75		103	250	80	1.400	842552
2104075010	75	x	103	250	4	0.200	
2104110000	110		147	300	90	2.200	842554
2104110010	110	x	147	300	4	0.270	
2104160000	160		203	350	110	3.800	842556
2104160010	160	x	203	350	4	0.320	
2104200000	200		245	400	120	5.200	842558
2104200010	200	x	245	400	4	0.400	