

## Looped piece with screw socket SYNOFLEX BAIO<sup>®</sup>, PN 16

5346

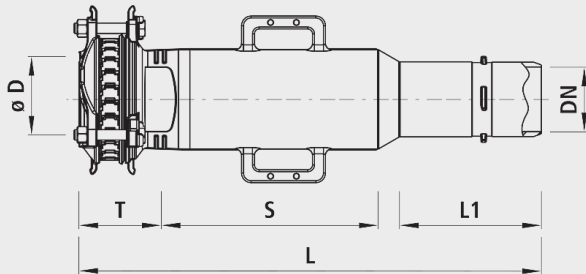

### Application

- For the subsequent installation of all BAIO<sup>®</sup> fittings in existing lines made from cast, steel, eternit and plastic pipes.
- The longer range coupling HAWLESYNOFLEX is the economical alternative to welding technology. It is used in the drinking water supply and waste water disposal. It is used for a shear-protected connection of all the customary types of pipes made from cast, steel, PE, and PVC or for connecting pipes with different external diameters, as well as in poor weather conditions in particular. Shear protection is not guaranteed when using fiber cement pipes.

### Material

- Housing
  - Spheroidal graphite cast iron EN-GJS-400 (GGG 40)
  - EWS coating according to GSK, RAL-GZ 662, coating thickness min. 250 µm
- Seals
  - EPDM
- SYNOFLEX-Ring
  - POM
- Pull protection element
  - Steel, protected against corrosion
  - Mounted on every individual support element
- Bolts
  - greased for life
  - with INOX antirotation lock

### Characteristics

- Permissible angle up to max. 8° (+/-4° per socket)
- Flange connection compound
  - according to EN 1092-2
- Operating temperature
  - max. 40 °C
- SVGW certified
- Pressure PN 16

### Caution

- For the fiber cement pipes tensile strength is not guaranteed.
- A supporting sleeve must be used without fail for high tensile connections of PE pipes.
- The maximum insertion depth must not be exceeded, in order to ensure a gap is maintained between the pipes or before the stop.

### Thrust protection

- High tensile connection in multiple areas for all types of pipes
- Unlatching security (No. 5290) for BAIO<sup>®</sup>-system

	<b>DN</b>	<b>ø D min./max.</b>	<b>PN (bar)</b>	<b>L (mm)</b>	<b>L1 (mm)</b>	<b>D (mm)</b>	<b>S</b>	<b>weight (kg)</b>	<b>NPK No. 412</b>
5346080000	80	84-105	16	740	210	117	414	19.000	235321
5346100001	100	104-132	16	720	220	119	347	21.000	235322
5346125001	125	131-160	16	776	230	119	366	27.800	235323
5346150001	150	155-192	16	780	235	126	377	34.000	235324
5346200001	200	198-230	16	845	260	143	408	53.000	235325
5346200000	200	230-260	16	880	280	150	420	60.000	
5346250001	250	265-310	16	885	255	155	411	74.000	235326
5346300001	300	313-356	16	915	255	161	438	102.000	235327