

Analog position indicator 4 till 20 mA

1960

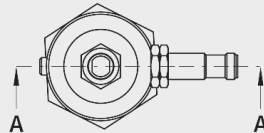
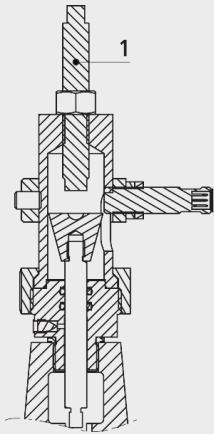

Application

- The analogue position indicator is mounted on the central outlet of the valve cover. It is used for the electric signalling of an analogue valve position (0 to 100%).

Material

- INOX

| | DN | weight (kg) |
|-----------|-------------|-------------|
| 196000001 | 1 1/2" - 50 | 1.100 |
| 196000002 | 65-100 | 1.100 |
| 196000003 | 125-200 | 1.350 |
| 196000004 | 250 | 1.710 |
| 196000005 | 300 | 1.710 |