

Dual-chamber flange for cast pipes, thrust protected, PN 16

7110

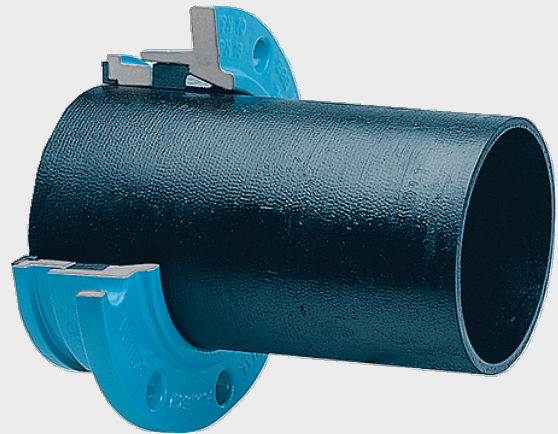
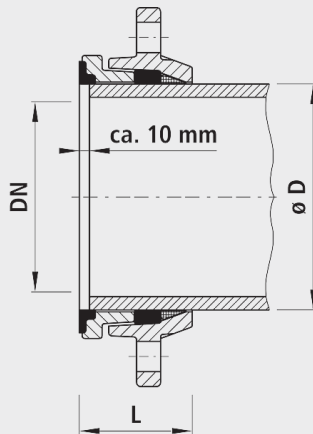

Application

- Die Zweikammerflansch-Technik löst Verbindungs- und Übergangsprobleme aller Art. Sie ist für alle Bereiche des Rohrleitungsbaus einsetzbar. Bei Abweichungen von Normnennweiten sind auf Anfrage auch Sonderanfertigungen möglich.

Characteristics

- Quick and easy installation
- Secure sealing
- Removable at any time
- Flange connection compound
 - according to DIN EN 1092-2
 - DN 25 to DN 150: PN 10 / 16
 - DN 200 to DN 600: PN 10 or 16, specify when ordering
- Operating temperature
 - max. 40 °C

Installation and assembly











- Cut the pipe ends off at a right angle, do not bevel
- Slide the flange as well as the thrust collar on the smooth pipe end. Slide the entire flange up to the counterflange, so that the thrust ring with seal projects from the pipe end by approx. 10mm. Tighten the screws securely in a crosswise direction. Repeat the tightening procedure as often as necessary until all the screws are securely tightened and the connection is sealed.

Material

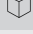
- Spheroidal Cast Iron EN-GJS-400 (GGG 40)
- EWS coating according to GSK, RAL-GZ 662, layer thickness min. 250 μm

Caution

- For cast pipes to EN 545
- Do not use any additional flange seals.
- Pipe tolerance acc. (see Chapter i)
- Note the screw lengths
- Cannot be used on high-alloy steel and chrome steel tubes, since the shear protection is not guaranteed!

	DN	ø D (mm)	PN (bar)	L (mm)	weight (kg)	NPK No. 411	NPK No. 412	BIM / CAD
7110050066	50	66	16	70	3.000	278236	273118	
7110065082	65	82	16	80	3.900	278237	273119	
7110080098	80	98	16	75	4.000	278238	273121	
7110100118	100	118	16	80	4.500	278239	273122	
7110125144	125	144	16	85	6.000	278241	273123	
7110150170	150	170	16	100	9.400	278242	273124	
7110200222	200	222	10	105	14.000	278243	273145	
7110201222	200	222	16	105	14.000	278243	273165	
7110250274	250	274	10	105	17.600	278244	273146	
7110251274	250	274	16	105	17.600	278244	273166	
7110300326	300	326	10	105	21.000	278245	273147	
7110301326	300	326	16	105	21.000	278245	273167	

L = Mounted length